

WORLDBLOCK

the World's #1 Block Form Company

V-INTERLOCK BLOCK FORM

■ PAGE 2

KNOB STYLE BLOCK FORM

■ PAGE 10

U-Anchors

■ PAGE 14

FORM LINERS

■ PAGE 15

LANDSCAPE BLOCK FORMS

■ PAGE 18

MID-SIZE BLOCK FORM

■ PAGE 30

Other Accessories

■ PAGE 37

SUMMER / FALL 2025

■ V-INTERLOCK BLOCK FORMS



The granddaddy of all block forms, the V-Interlock block form has been used for years in the industry as the go-to form.

Down and dirty, the V-Interlock Block is not meant to be pretty, it's meant to get the job done. At 2 feet high, 2 feet wide and 6 feet long, the block form takes 24 cubic feet of concrete to make a 3,600 pound block. If you need to get rid of a cubic yard of concrete, this form will do the trick.

The granddaddy of all block forms, the V-Interlock block form has been used for years in the industry as the go-to form for straight-forward, get-it-done-now applications. These blocks are perfect (and most commonly used) for industrial applications such as batch plant fencing and product divider bins.

A raised "male" V notch runs along the top and down one side of the block while an inner

"female" V notch runs along the bottom and up the other side. V-Interlock blocks are the only blocks to interlock on all four sides.

Built as two "L" shaped halves your forms lock together at the corners using two heavy-duty, over-center locking clamps. This design allows for easy set up and stripping. The clamps can be used as levers to help you pop the form open after the block has cured.

A convenient liftpoint blockout is already welded in place. With the addition of a 7/16" U-Anchor Blockout (AC-040V) you can start casting in 7/16x9 U-Anchors (AC-041) to create the safest & easiest way to lift and handle your finished blocks. The reinforced sidewalls make your forms rigid enough to

handle the biggest load.

The forms are poured with the face down. The sides of the form make the top, bottom and sides of the block. After stripping, just grab the liftpoint and tip the block upright.

To make a more decorative block use a form liner. These durable urethane liners are placed on the bottom of the form and create stone patterns on the front of your blocks.

Straight walls are easy to create. You will only need two forms. A 6 foot form will create blocks for the bulk of the wall. And a 3 foot form will offset the end for a running bond pattern. Getting rid of concrete has never been easier.

" Use U-Anchor Blockout AC-040V with the 7/16x9 U-Anchor (AC-041) to create the safest & easiest way to handle your finished blocks "

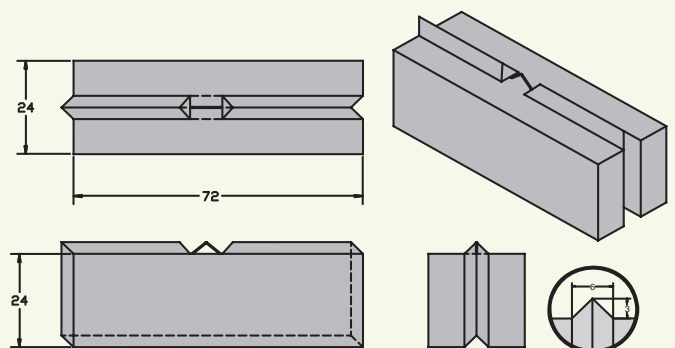



■ 2' X 2' X 6' STRAIGHT

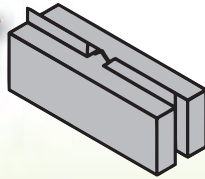

■ Sku Number: VC-STR72
Form Weight: 300 lbs
Block Weight: 3,600 lbs
Volume: 24.00 cu. ft.

\$925.00

■ 2' X 2' X 4' STRAIGHT

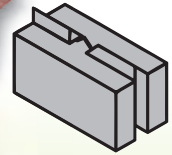

■ Sku Number: VC-STR48
Form Weight: 200 lbs
Block Weight: 2,400 lbs
Volume: 16.00 cu. ft.

\$710.00

■ 2' X 2' X 3' STRAIGHT

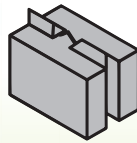

■ Sku Number: VC-STR36
Form Weight: 185 lbs
Block Weight: 1,800 lbs
Volume: 12.00 cu. ft.

\$650.00

■ 2' X 2' X 2' STRAIGHT

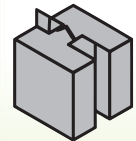

■ Sku Number: VC-STR24
Form Weight: 150 lbs
Block Weight: 1,200 lbs
Volume: 8.00 cu. ft.

\$600.00



Call Now 218-728-9481

■ V-INTERLOCK BLOCK FORMS

When you make a junction, be it just a corner or a "T" intersection, you will need a special block to do the job. World Block® has all the forms you need to make any of these connections.

The V-Interlock Blocks have a V-groove running along its lengths. Any intersection of your wall must address this groove.

While this may seem tricky at first, once you get the hang of it, it's a piece of cake. And, of course, if you have any questions, you can just give us a call.



■ 2' X 2' X 5'
CORNER



■ Sku Number: VC-CNR60
Form Weight: 255 lbs
Block Weight: 3,000 lbs
Volume: 20.00 cu. ft.

\$810.00

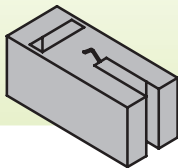

■ 2' X 2' X 4'
CORNER



■ Sku Number: VC-CNR48
Form Weight: 195 lbs
Block Weight: 2,400 lbs
Volume: 16.00 cu. ft.

\$750.00

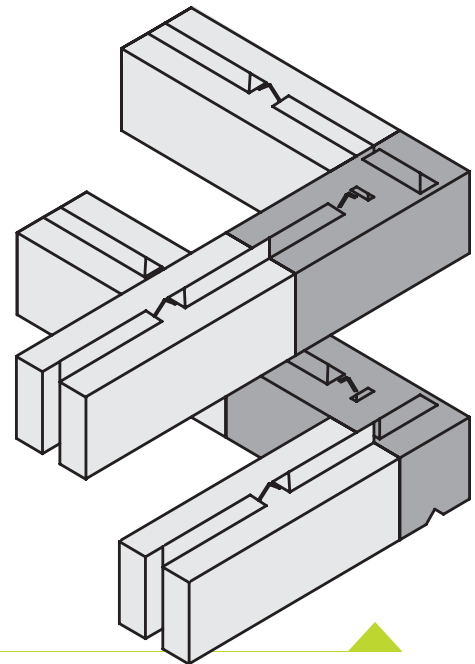
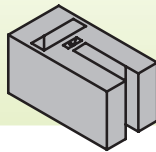

The corner block is used to interlock overlapping corner blocks. This block has one two-foot section of the top V-groove turned 90° allowing it to accept the groove of the block placed on top

of it. Because the corner block overlaps the block below it by 2 feet, the 5 foot length will allow you to maintain your running bond after turning the corner.



■ 2' X 2' X 5'
T-BLOCK



■ Sku Number: VC-TBL60
Form Weight: 255 lbs
Block Weight: 3,000 lbs
Volume: 20.00 cu. ft.

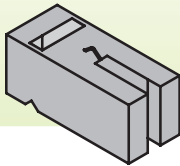

\$890.00

■ 2' X 2' X 4'
T-BLOCK



■ Sku Number: VC-TBL48
Form Weight: 200 lbs
Block Weight: 2,400 lbs
Volume: 16.00 cu. ft.

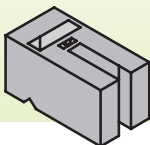

\$830.00



*What if I don't
have enough
concrete to fill
my form?*

Not a problem. The face of the block is the only part of the block that people will see. Because your blocks are poured face down, the block face will always look good. If you run out of concrete, simply drop a couple of pieces of rebar in the wet concrete. When you have more concrete, fill it up the rest of the way. The rebar will lock the two pours together.

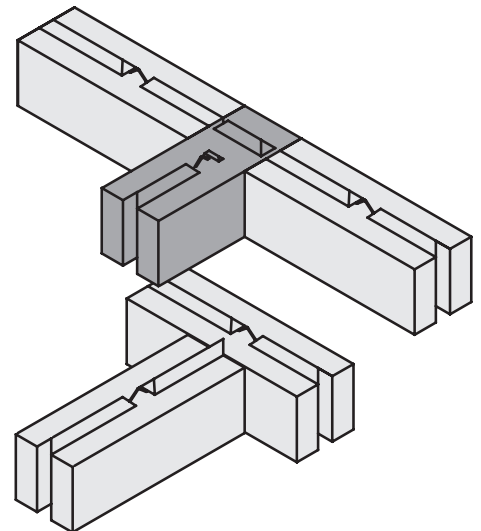

The T-block is used for creating "T" junctions for partition walls. The block can be used as both a corner block and a T-block. This block has one two-foot section of top V-groove turned 90° and one two-foot section of bottom V-groove turned 90° allowing

it to interlock with blocks running above and below it. Because the T-block overlaps the block below it by 2 feet, the 5 foot length will allow you to maintain your running bond after turning the corner.

Call Now 218-728-9481

■ V-INTERLOCK BLOCK FORMS



This block can be used as a straight, corner or "T" block. The combination block is designed just like the straight block with the addition of two V-grooves that are turned 90° running across the

bottom. These grooves are set back from the edge by 2" to hide the notches when they are used as straight blocks. To use the block as a corner or "T" block simply break off that chunk of concrete.

Also this setback provides enough space to use liners with the form.

■ 2' X 2' X 6' COMBINATION

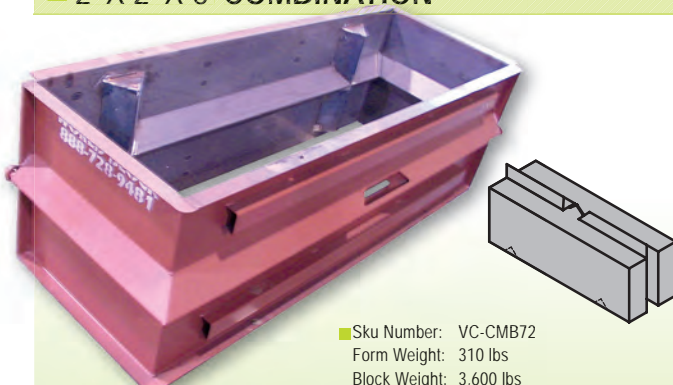

\$995.00

■ Sku Number: VC-CMB72
Form Weight: 310 lbs
Block Weight: 3,600 lbs
Volume: 24.00 cu. ft.

■ 2' X 2' X 4' COMBINATION



\$780.00

■ Sku Number: VC-CMB48
Form Weight: 210 lbs
Block Weight: 2,400 lbs
Volume: 16.00 cu. ft.



There are two different ways to make a top cap for your V-Interlock Blocks. The first is with a Top Cap Insert. The Top Cap Insert is placed lengthwise into your existing six foot block form. The insert will create a 12" high cap with chamfered edges and is flush with the sides of the blocks underneath it. Note that it retains the end interlocks. The second way is with a separate Top Cap Form. This form

creates a top cap that is 26" wide x 6' long x 6" high with a 12:2 pitch to center peak (8" thick at center) and 1 inch overhang on each side of block. It is poured upside down and flipped over using the trunnions on each end. Loosen the quickbolts on each corner and release the V-notch pan and your block will slide right out. Used with a 45° Top Cap Blockout you can neatly turn a 90° corner.



■ TOP CAP BLOCKOUT

■ Sku Number: VC-CAP72B
Form Weight: 175 lbs
Block Weight: 1,800 lbs
Volume: 12.00 cu. ft.

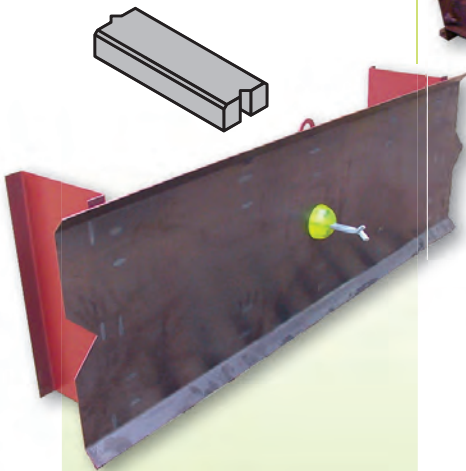

\$425.00

■ TOP CAP FORM

■ Sku Number: VC-CAP72F
Form Weight: 365 lbs
Block Weight: 1,050 lbs
Volume: 7.00 cu. ft.

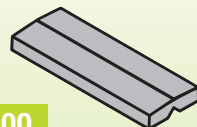
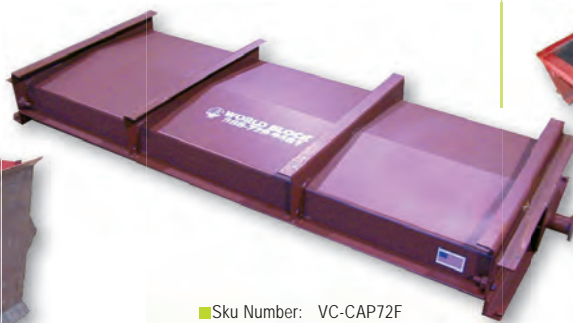

\$825.00

■ 45° TOP CAP BLOCKOUT

■ Sku Number: VC-CAP45B
Form Weight: 20 lbs
Block Weight: 900 lbs
Volume: 6.00 cu. ft.

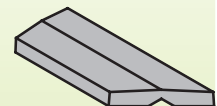

\$55.00

Call Now 218-728-9481

■ V-INTERLOCK BLOCK FORM ACCESSORIES

Top Recess Blockout for V-Interlock Form

Sku Number: VC-R2472 (for 24"x72" V-Interlock Form)

Weight: 100 lbs.

Price: \$495.00

Sku Number: VC-R2448 (for 24"x48" V-Interlock Form)

Weight: 80 lbs.

Price: \$465.00

Sku Number: VC-R2436 (for 24"x36" V-Interlock Form)

Weight: 70 lbs.

Price: \$435.00

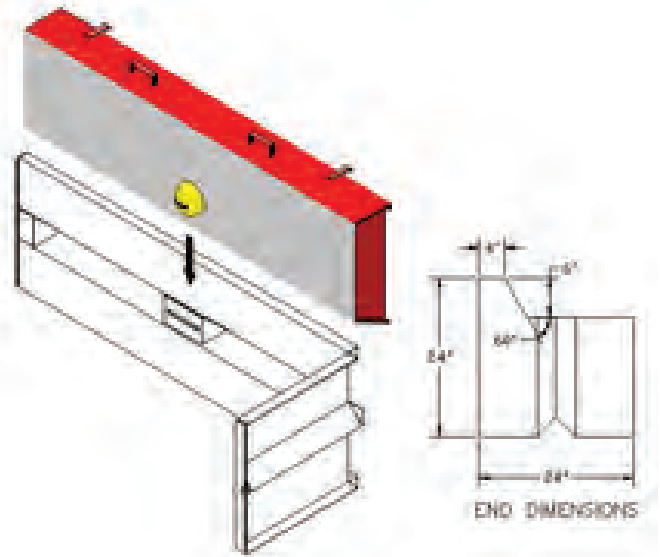

Description: This blockout allows you to create recessed Top blocks.

Place rock or sod within 4" of the face of the block. 4" thick Formliners will not work with the Recess blockout shown, call us to get the correct Part Number for use with Formliners.

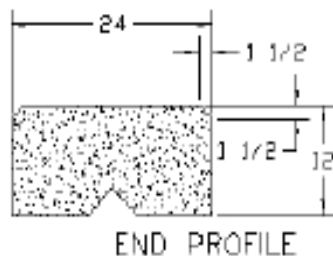

V-Interlock Top Cap Form - 24"Wx12"Hx72"L
"V" on Bottom Only; Chamfered Top Edges

Sku Number: VC-CAP122472F

Weight: 200 lbs.

Price: \$825.00

Description: This form allows you to pour a V-Interlock Cap that is 24"W x 12"H x 72"L with Chamfered top edges. A blockout for U-Anchors or Rebar is included with the form to make your finished Caps easy to handle.

V-Notch for Vertical Side of a Corner Block Form

Sku Number: VC-VN003
Part Weight: 25 lbs.
Price: \$195.00



Description: This part bolts into the top of a Corner Block Form and allows you to cast a Vertical female "V" into the side of the Corner block to accept the end "V" of a block butting up against it.

Flat Top Blockout for V-Interlock Form

Sku Number: VC-72FTB (for 24"x72" V-Interlock Form)
Weight: 80 lbs.
Price: \$295.00

Sku Number: VC-48FTB (for 24"x48" V-Interlock Form)
Weight: 65 lbs
Price: \$275.00

Sku Number: VC-36FTB (for 24"x36" V-Interlock Form)
Weight: 45 lbs.
Price: \$255.00



Description: This blockout allows you to create blocks with Flat Tops. It has a slot in the side that allows you to use the same rebar or U-Anchors that you use with your standard blocks.

24"x24" Moveable Bulkhead

Sku Number: VC-2424BULK
Weight: 75 lbs.
Price: \$325.00

Description: The Moveable Bulkhead allows you to create blocks of varying length. You can move the Bulkhead to your desired block length and hold it in the correct position by spacing it in from the end using 2x4's or 4x4's. When using this Bulkhead you may also need a Rubber V-Interlock Rebar Blockout - Magnetic (Sku AC-080M \$55.00) since your center of gravity / lift point will change as you move the Bulkhead.



■ KNOB STYLE BLOCK FORMS



Just about the simplest block form out there, the knob style block form makes life easy. With two knobs on top fitting into two knobs on the bottom, these blocks fit together consistently every time.

We have 2 sizes of Knob Style blocks: 24"x24"x48" requiring 16 cubic feet of concrete (making a 2,400 pound block) and 30"x30"x60" requiring 31 cubic feet of concrete (making a 4,700 pound block).

This block is purposely built half as wide as they are long. Because of this, turning a corner does not require buying extra forms or pouring special blocks. The knob placement and block dimensions allow you to simply turn your block 90° at a corner and maintain a running bond.

The forms are built as two

"L" shaped halves that lock together with heavy-duty, over-center locking clamps for easy set-up and stripping. The clamps can be used as levers to help you pop the form open after the block has cured. This design allows you to get many pours per day from one form. After your first pour has set, strip the form and leave the block to cure. Then set the form up and pour again. Depending on your mixture you may be able to get multiple pours per day from one form.

The blocks are poured face down. After stripping, grab the liftpoint and tip upright. To make a more decorative block use a form liner. These durable urethane liners are placed on the bottom of the form to create decorative stone patterns on the face of your blocks.

Half blocks can be created in two ways: in a separate form or with a blockout. The blockouts fit inside your existing, full form allowing you to pour in half of the form. The only disadvantage to using a blockout is that it will tie up your large form for at least one pour. If you do decide to use a half block blockout, two holes will have to be drilled in the top knob of the form to hold the rubber liftpoint blockout. When not pouring half blocks, a piece of duct tape will cover the holes perfectly.

Similarly, top cap blocks can be made with either a form or a blockout. And the same rules apply - if you use a blockout you tie up a form. You can also create half top caps.

When you reach the end of

a wall it can sometimes look better to slope the wall down rather than end it abruptly. For these instances we offer a Sloped End Blockout that fits securely into the corner of the form. You can create right and left slopes by moving the blockout from one corner to the other.

With the form's ease of use and the block's simple functionality, it is no surprise that some of our most popular block forms are knob style.

* For the 24x24x48 Knob Style use the 3/8x7 U-Anchor (AC-031) with the 3/8" U-Anchor Blockout (AC-030)
* For the 30x30x60 & Jumbo Knob Style use the 7/16x9 U-Anchor (AC-041) with the 7/16" U-Anchor Blockout (AC-040)



■ 24" X 24" X 48" FULL KNOB BLOCK FORM

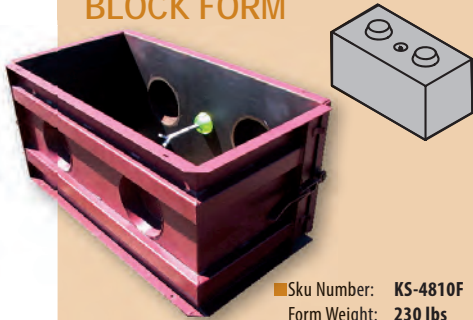

■ Sku Number: **KS-4810F**
Form Weight: **230 lbs**
Block Weight: **2,400 lbs**
Volume: **16.00 cu. ft.**

\$975.00

■ 12" X 24" X 48" FULL KNOB TOP CAP FORM

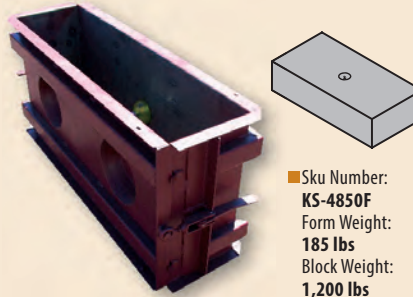

■ Sku Number: **KS-4850F**
Form Weight: **185 lbs**
Block Weight: **1,200 lbs**
Volume: **8.00 cu. ft.**

\$795.00

■ 12" X 24" X 24" HALF KNOB TOP CAP FORM

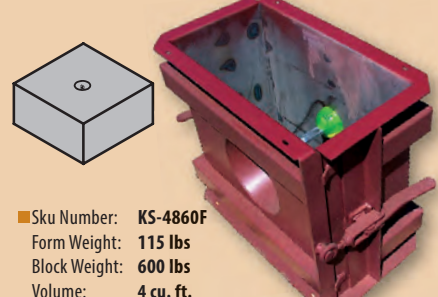

■ Sku Number: **KS-4860F**
Form Weight: **115 lbs**
Block Weight: **600 lbs**
Volume: **4 cu. ft.**

\$655.00

■ 24" X 24" X 24" HALF KNOB BLOCK FORM

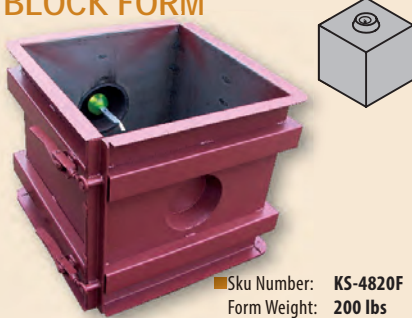

■ Sku Number: **KS-4820F**
Form Weight: **200 lbs**
Block Weight: **1,200 lbs**
Volume: **8.00 cu. ft.**

\$795.00

■ BLOCKOUT



■ Sku Number: **KS-4850B**
Form Weight: **90 lbs**
Block Weight: **1,200 lbs**
Volume: **8.00 cu. ft.**

\$390.00

BLOCKOUT



■ Sku Number: **KS-4860B**
Form Weight: **40 lbs**
Block Weight: **600 lbs**
Volume: **4.00 cu. ft.**

\$360.00

BLOCKOUT

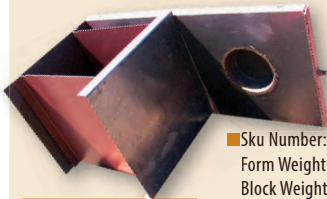

■ Sku Number: **KS-4820B**
Form Weight: **90 lbs**
Block Weight: **1,200 lbs**
Volume: **8.00 cu. ft.**

\$365.00

■ 24" X 24" X 48" KNOB SLOPED END BLOCKOUT



■ Sku Number: **KS-4870B**
Form Weight: **80 lbs**
Block Weight: **1,800 lbs**
Volume: **12.00 cu. ft.**

\$375.00

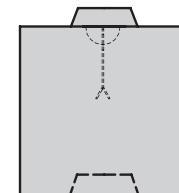
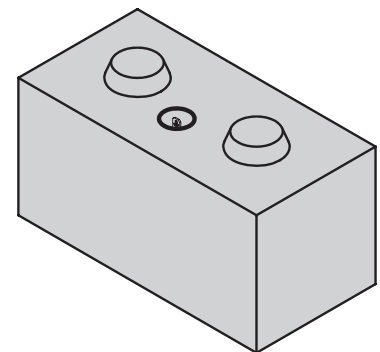
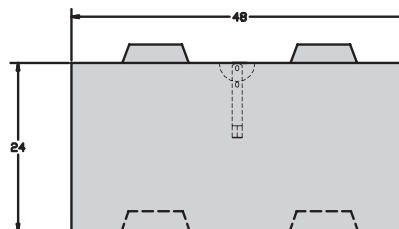
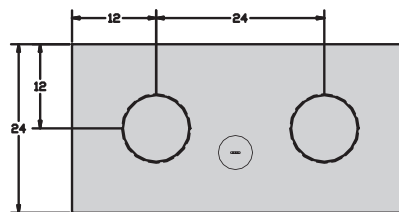

■ KNOB STYLE BLOCK FORMS

■ 30" X 30" X 60" FULL KNOB BLOCK FORM

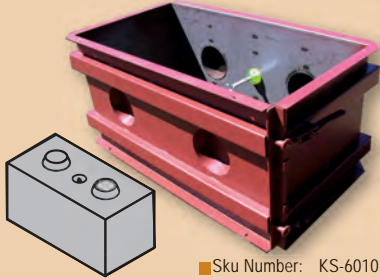

■ Sku Number: KS-6010F
Form Weight: 370 lbs
Block Weight: 4,700 lbs
Volume: 31.33 cu. ft.

\$1,125.00

■ 15" X 30" X 60" FULL KNOB TOP CAP FORM

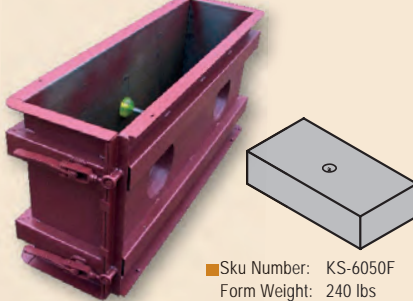

■ Sku Number: KS-6050F
Form Weight: 240 lbs
Block Weight: 2,350 lbs
Volume: 15.67 cu. ft.

\$850.00

■ 15" X 30" X 30" HALF KNOB TOP CAP FORM

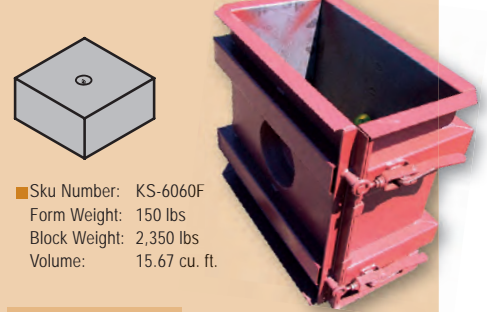

■ Sku Number: KS-6060F
Form Weight: 150 lbs
Block Weight: 2,350 lbs
Volume: 15.67 cu. ft.

\$695.00

■ 30" X 30" X 30" HALF KNOB BLOCK FORM

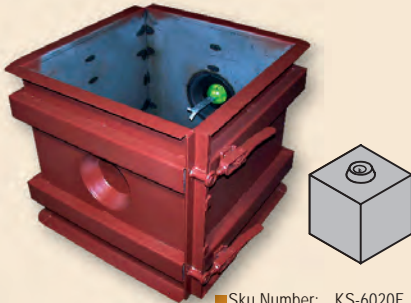

■ Sku Number: KS-6020F
Form Weight: 260 lbs
Block Weight: 2,350 lbs
Volume: 15.67 cu. ft.

\$850.00

■ 15" X 30" X 60" FULL KNOB BLOCKOUT



■ Sku Number: KS-6050B
Form Weight: 125 lbs
Block Weight: 2,350 lbs
Volume: 15.67 cu. ft.

\$420.00

■ 15" X 30" X 30" HALF TOP CAP BLOCKOUT



■ Sku Number: KS-6060B
Form Weight: 55 lbs
Block Weight: 1,175 lbs
Volume: 7.83 cu. ft.

\$390.00

BLOCKOUT

■ Sku Number: KS-6020B
Form Weight: 125 lbs
Block Weight: 2,350 lbs
Volume: 15.67 cu. ft.

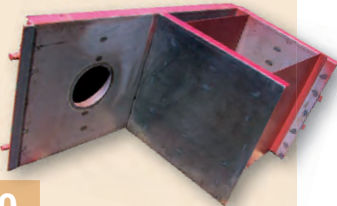

\$395.00

■ 30" X 30" X 60" SLOPED END BLOCKOUT

\$395.00

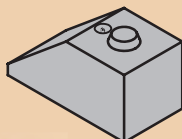

■ Sku Number: KS-6070B
Form Weight: 115 lbs
Block Weight: 3,500 lbs
Volume: 23.33 cu. ft.

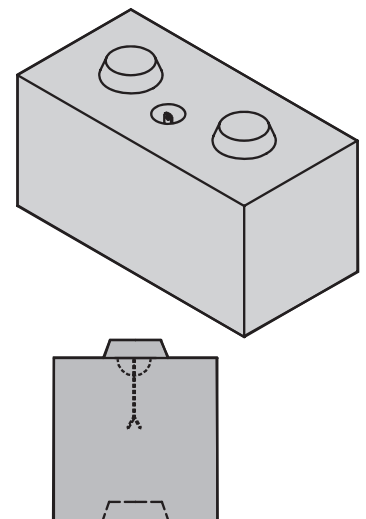
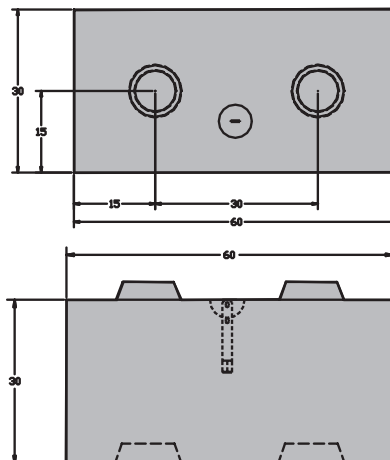



The biggest of the Knob Blocks, the Jumbo Block certainly knows how to throw its weight around. Weighing in at 5,400 pounds with 36 cubic feet of concrete, the Jumbo Block stays where you put it. Working just like the knob style block form, with its simple interlocking system, the Jumbo Block makes an imposing wall.

The front face of the block is a well proportioned 2 feet by 6 feet. At 3 feet deep the block is half as deep as it is long and will easily turn a corner without disrupting your running bond pattern.

When you need to make a big wall, you need a big block. The Jumbo Block will fit the bill.

■ 24" X 36" X 72" JUMBO BLOCK FORM

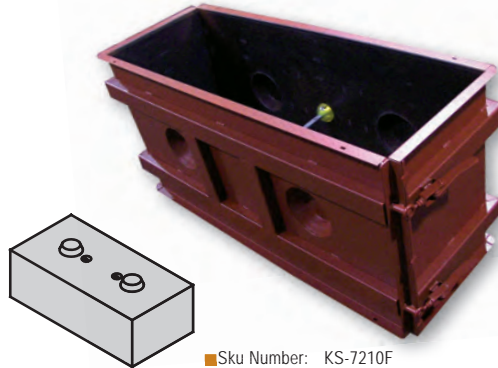

■ Sku Number: KS-7210F
Form Weight: 580 lbs
Block Weight: 5,400 lbs
Volume: 36.00 cu. ft.

\$1,625.00

■ 24" X 36" X 36" JUMBO HALF BLOCK (BLOCKOUT)

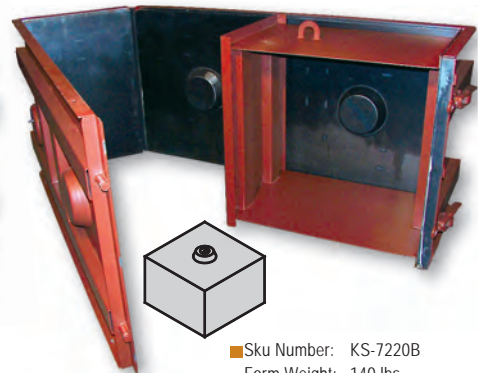

■ Sku Number: KS-7220B
Form Weight: 140 lbs
Block Weight: 2,700 lbs
Volume: 18.00 cu. ft.

\$420.00

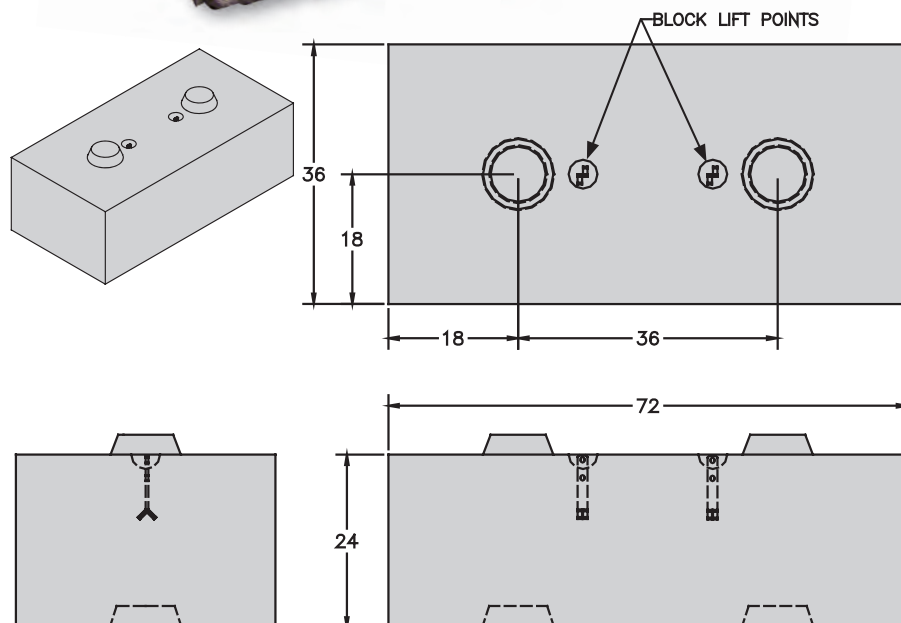

■ ACCESSORIES

1/4" LIFTPoint BLOCKOUT

fits 1/4" U-Anchor and 1/4" Lifting Loop



\$30.00

1/4" BLOCKOUT

■ Sku Number: AC-020
Weight: 2 lbs

3/8" LIFTPoint BLOCKOUT

fits 3/8" U-Anchor and 3/8" Lifting Loop



\$30.00

3/8" BLOCKOUT

■ Sku Number: AC-030
Weight: 2 lbs

7/16" LIFTPoint BLOCKOUT

Fits 7/16" U-Anchor



\$30.00

7/16" BLOCKOUT

■ Sku Number: AC-040
Weight: 2 lbs

1/4" U-ANCHOR

For use with Mid-Size Landscape block forms
(Rated to 1,600 lbs)

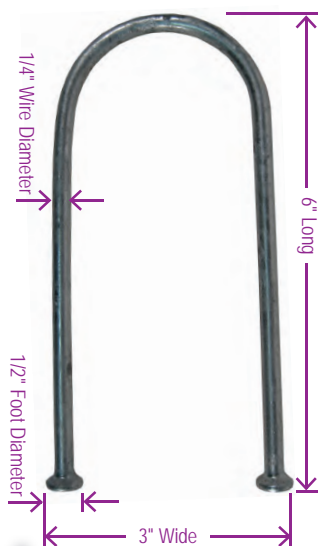

\$1.45

■ Sku Number: AC-021
Weight: 2.7 oz.

Only: \$1.25 when
ordering 100+

3/8" U-ANCHOR

For use with Landscape and 24 x 48 Knob Style
block forms (Rated to 4,690 lbs)

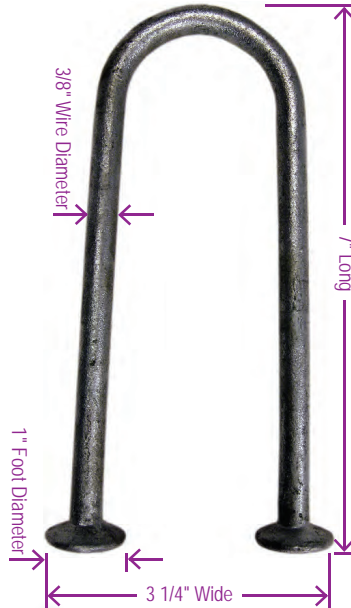

\$1.85

■ Sku Number: AC-031
Weight: 8.8 oz.

Only: \$1.65 when
ordering 100+

7/16" U-ANCHOR

For use with V-Interlock and 30 x 60 Knob Style
block forms (Rated to 7,500 lbs)

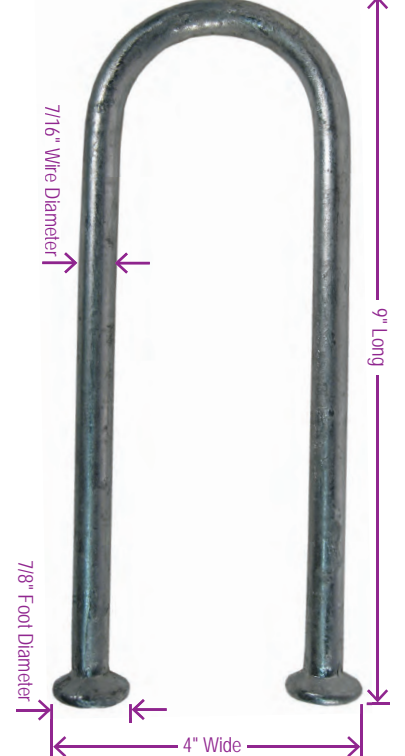

\$2.55

■ Sku Number: AC-041
Weight: 16.5 oz.

Only: \$2.35 when
ordering 100+

U-ANCHORS

Made of galvanized carbon steel to prevent rust, the U-Anchor is the most economical lifting anchor on the market. U-anchors were designed specifically for lifting precast modular blocks.



"Formliners add dimension and visual interest to this wall."

Adding a decorative face to your concrete blocks adds value without adding cost. Meaning you can charge more for your blocks using the same amount of concrete. It's no wonder that this is one of the fastest growing segments of the concrete industry. World Block offers a wide array of urethane liners to simply and efficiently create decorative stone patterns on the face of your finished blocks. Our liners come in three different depths, 1", 2" and 4". The thicker liner will give you a deeper, more aggressive texture. World Block Forms are poured face down. To use a liner you simply place the liner at the bottom of the form and fill it up

with concrete. After stripping the form, tip the block upright and the liner will peel right off. Your block will then have your chosen pattern on its face. World Block Liners are made of a very durable, 65 durometer urethane. With proper care you can expect to get hundreds of uses from your form liner. Don't leave them out to dry and crack in the elements. And be sure to use the proper release agent with them. While there are many release agents to choose from, we recommend using Unitex / Dayton Superior Q-2 VOC with our liners. If you decide to use a release agent other than this, be sure to test it to ensure it doesn't shrink, expand or other-

wise eat away at your liners. Coloring your blocks can be done in three different ways. Either with an admixture colorant, a colored power release agent, or a concrete stain. Most people are using stains to color their block walls. A typical application is to spray on a base coat over the entire wall. This covers any variations of color from block to block. Then two or three more colors can be sponged, or ragged onto the individual "stones" to create a more natural look. Form liners are very easy to use and increase value without adding material costs. You make more money without pouring more concrete. That's getting something for nothing!

Our liners come in a variety of thicknesses. This not only affects the cost, but the look of the finished block. A 2 inch thick liner has a deeper relief than a 1 inch liner. Generally speaking a deeper relief will give you more contrast and greater detail. But before making a decision, think about the finished wall's use. If it's on the side of a highway, detail won't matter much at 50 yards and 50 mph. If the wall is being constructed in a park where people will get close to it, the detail and depth of a thicker liner might be the way to go.

■ FORM LINERS

"With proper care you can expect to get hundreds of uses from your form liner."

1" CUT STONE



2" CHISELED STONE



1" RIVER ROCK



2" RIVER STONE



1" RANDOM STACK



2" LIMESTONE



4" LANDSCAPE

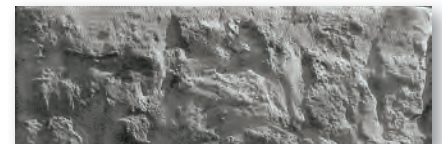

1" ROCK FACE



2" SPLIT FACE

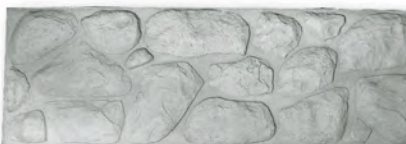

4" MULTI-STONE



How do I color my blocks?

Get the longest life out of your Formliners :

1. Use the recommended Release Agent (Unitex Q2).
2. Store your liners out of the elements when not in use - exposure to the sun will cause the urethane to harden and break down.
3. When possible, pick your blocks straight up off of the liner versus tipping the block on the liner.

■ 1" LINER PRICING

24"X72"X1"	50 lbs	\$495.00
24"X60"X1"	42 lbs	\$435.00
24"X48"X1"	34 lbs	\$370.00
24"X36"X1"	26 lbs	\$305.00
24"X24"X1"	18 lbs	\$240.00
30"X60"X1"	55 lbs	\$505.00
30"X30"X1"	27 lbs	\$305.00

■ 2" LINER PRICING

24"X72"X2"	80 lbs	\$520.00
24"X60"X2"	67 lbs	\$455.00
24"X48"X2"	53 lbs	\$390.00
24"X36"X2"	40 lbs	\$320.00
24"X24"X2"	27 lbs	\$250.00
30"X60"X2"	85 lbs	\$535.00
30"X30"X2"	43 lbs	\$325.00

■ 4" LINER PRICING

24"X72"X4"	90 lbs	\$720.00
24"X60"X4"	77 lbs	\$625.00
24"X48"X4"	60 lbs	\$525.00
24"X36"X4"	52 lbs	\$430.00
24"X24"X4"	35 lbs	\$320.00
30"X60"X4"	100 lbs	\$750.00
30"X30"X4"	50 lbs	\$450.00





WORLD BLOCK FORMLINER POURING INSTRUCTIONS:

Coat your Formliners with a suitable Release Agent

Before each use, apply a coat of Release Agent to the Formliner per the Release Agent manufacturer's instructions. Check with them prior to the first application to make sure that the Release Agent is suitable for use with Urethane Rubber. Improper Release Agents will cause the Formliner to swell, shrink or prematurely de-grade. ***Protect your investment and check before you apply Release Agent for the first time!***

Do not wait more than 1 to 2 hours to pour Concrete after applying the Release Agent, it is most effective immediately after it has been applied. Even though Release Agent is often mineral or oil-based, it may run off or evaporate the longer it sits after application to the Formliner.

World Block recommends the following Release Agent for use with our Formliners:

Unitex Q-2 VOC by White Cap / Dayton-Superior (ph: 888-977-9600)

World Block sells Unitex Q-2 VOC in 5-gallon buckets (our Part #AC-120). If you want to buy 55-gallon drums or Tote quantities we recommend contacting your local Unitex / White Cap / Dayton-Superior distributor.

Most Release Agents are best applied using an Industrial Sprayer with chemical resistant seals. We sell an Industrial Sprayer (our Part #SP-060) for this purpose.

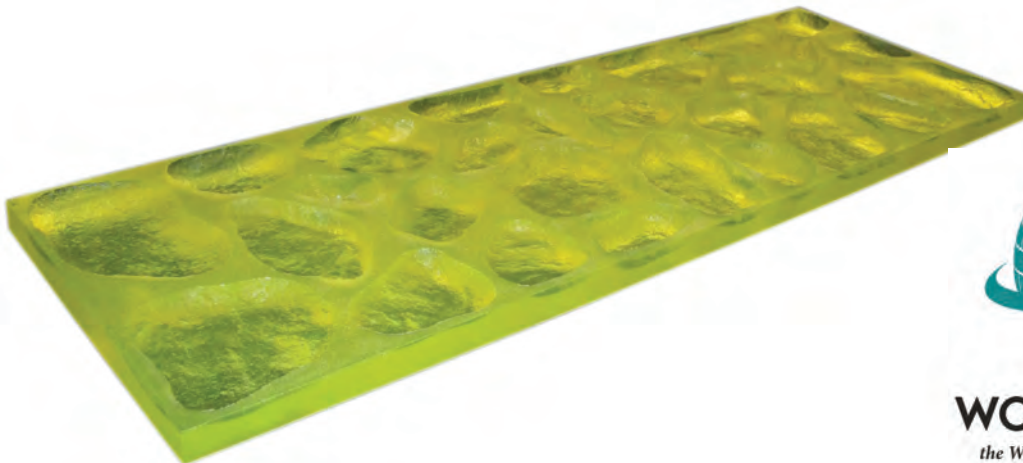

Call Now 218-728-9481

■ LANDSCAPE BLOCK FORMS



It can be said that World Block Landscape Block Forms are the building blocks of this country. Since their introduction, these forms have been responsible for building thousands of walls around the nation. Why are they so popular?

Simplicity and functionality. As with all World Block forms, the Landscape Block Form was created to get the

job done quickly and with minimal headache. This one form performs many tasks so you don't have to waste money on needless forms.

The basic form creates straight edge blocks for straight walls. Add the tapered end inserts and now your blocks can create curved walls with up to a 14 foot radius (measured to the back of the block). And by simply

bolting the half block divider into your form you can pour two half blocks at one time all with the same form.

The form is built with two "L" shaped halves that lock together with heavy-duty, over-center locking clamps for easy set-up and stripping. The blocks are poured face down with the liner on the bottom of the form to create the large rock face.

This design allows you to get many pours per day from one form. After your first pour has set, strip the form and leave the block to cure face down on its liner. Set the form up around a second liner and pour again. Depending on your mixture you can get two or three, even four blocks per day from one form.

The notch on the bottom of the block creates enough



"Landscape blocks allow you to control your terrain. Turn steep hills into usable space."

"slop" to allow the blocks to make curved walls. The notch pan comes bolted in place to allow the blocks to terrace back two inches on every course. The notch pan can be easily replaced if you want your blocks to lie flush.
* For the Landscape Block use the 3/8x7 U-Anchor (AC-031) with the 3/8" U-Anchor Blockout (AC-030)

■ 24" X 24" X 48" FULL BLOCK FORM

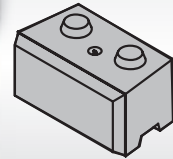

■ Sku Number: LS-1010S
Form Weight: 380 lbs
Block Weight: 2,400 lbs
Volume: 16.00 ft²

\$1,375.00

■ TAPERED END BLOCKOUTS

(PAIR) • (WORKS WITH STANDARD, SLOPED, AND CORNER FORMS)

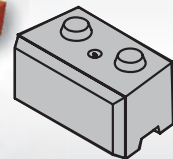

■ Sku Number: LS-1010T
Form Weight: 65 lbs
Block Weight: 2,250 lbs
Volume: 15.00 ft²

\$425.00

■ 24" X 48" X 4" LANDSCAPE LINER

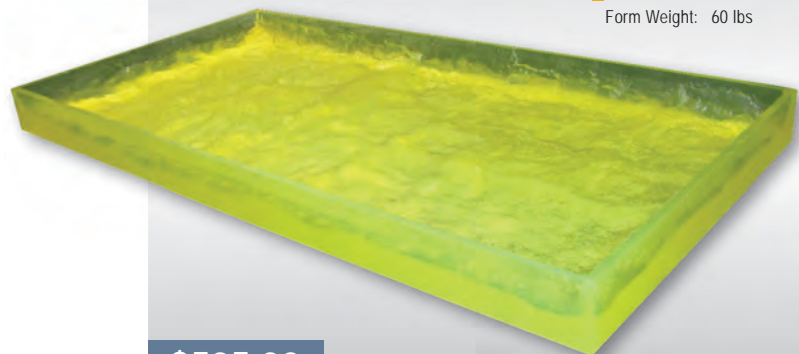

■ Sku Number: FL-LDS003
Form Weight: 60 lbs

\$525.00

Call Now 218-728-9481

■ LANDSCAPE BLOCK FORMS

Half blocks are used when finishing off the end of a wall when laid with a running bond. A divider will bolt into either a standard or corner form to create half blocks. When using a standard form, two liners are placed one on either side of the divider so you can create two half blocks in one pour. The tapered divider creates half blocks with tapered sides for laying curved walls. The straight divider creates straight sided blocks.

■ HALF BLOCK STRAIGHT DIVIDER

WORKS WITH STANDARD AND CORNER FORMS



■ Sku Number: LS-1020S
Form Weight: 50 lbs
Block Weight: 1,350 lbs
Volume: 9.00 ft²

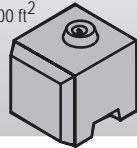

\$290.00

■ HALF BLOCK TAPERED DIVIDER

WORKS WITH STANDARD AND CORNER FORMS

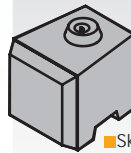

■ Sku Number: LS-1020T
Form Weight: 65 lbs
Block Weight: 1,200 lbs
Volume: 8.00 ft²



\$395.00

■ 24" X 24" X 4" LANDSCAPE HALF LINER

WORKS WITH STANDARD AND CORNER FORMS

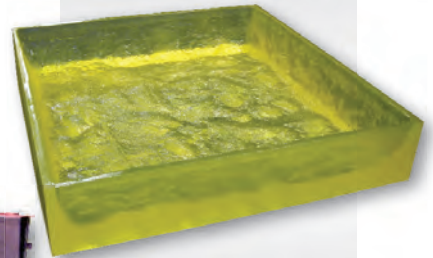

■ Sku Number: FL-LDS006
Form Weight: 25 lbs

\$320.00



"Half blocks help maintain your running-bond pattern."

■ LANDSCAPE KEY BLOCKS

THE PROBLEM:

Landscape blocks step back 2 inches on every course. When using corner blocks, they also step in 2 inches to adjust for the wall running in the other direction. If only one corner block is used, this offset is unnoticeable and easy to deal with. When using two corners, as shown below, the wall gets squeezed 4 inches on each course.

THE SOLUTION:

Key blocks are 4 inches shorter than the standard block - 44 inches versus 48. Use one additional key block for each successive course feeling the squeeze. For example, on the first course no key blocks are required. The second course needs one key block, the third course needs two, the fourth course needs three, and so on. At 12 courses the wall is being squeezed 48 inches and does not require a key block - simply start the pattern over again.

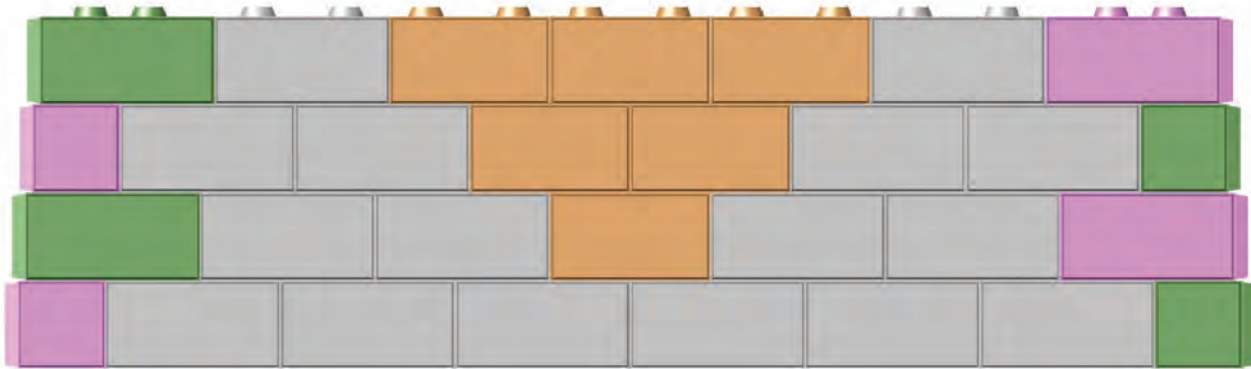

■ KEY BLOCK BLOCKOUT

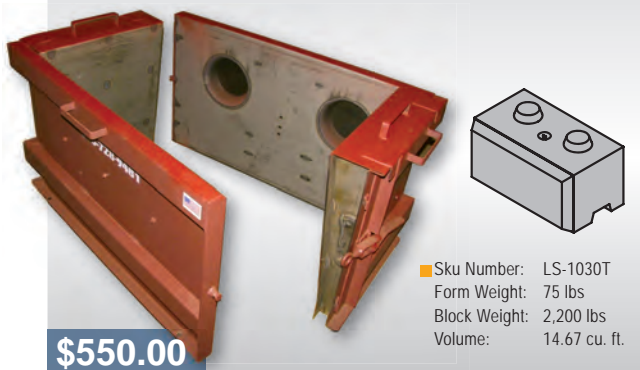

■ 24" X 44" X 4" KEY BLOCK LINER



■ LANDSCAPE "TAKEOFF" BLOCKS

When your wall "Takes Off" from a vertical structure, you will run into a situation where you need a 46" Long Block. In this instance you will need to use a Key Block Blockout (above) on one side of your Block Form only. Use this with a "Takeoff Liner" and you will create a 46" Long Block.

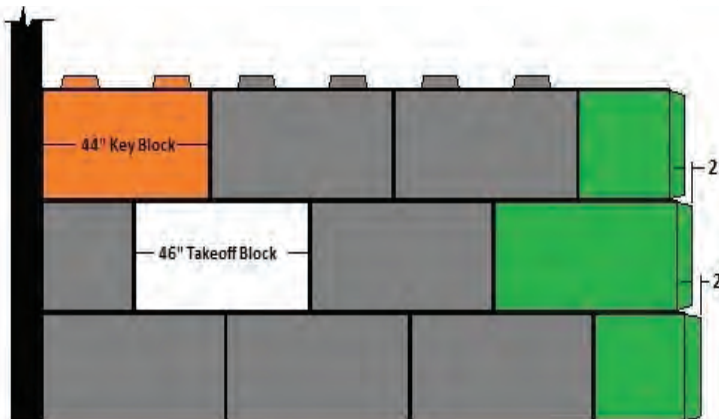

■ 24" X 46" X 4" "TAKEOFF" LINER

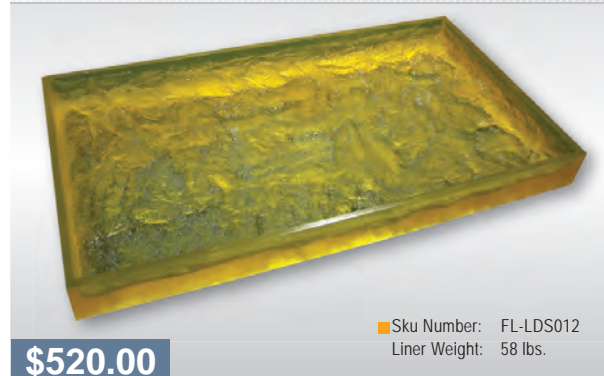

Call Now 218-728-9481

■ LANDSCAPE BLOCK FORMS

Corner blocks are used when you need to turn a 90 degree outside corner or when you simply want to finish off the end of a wall with a rock face. This form will create both a left and right facing block by just flipping the liner to the other side. The form is used with an "L" shaped liner that sits in the bottom and up one side of the form.



■ 24" X 28" X 24" X 52" X 4" CORNER LINER

■ Sku Number: FL-LDS121

Liner Weight: 75 lbs.

\$795.00



■ 24" X 28" X 24" X 28" X 4" HALF CORNER LINER

■ Sku Number: FL-LDS122

Liner Weight: 55 lbs.

\$605.00

■ CORNER BLOCK FORM

CREATES BOTH LEFT AND RIGHT BLOCKS

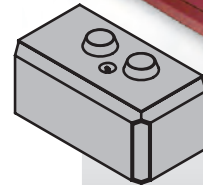

■ Sku Number: LS-1040S

Form Weight: 405 lbs

Block Weight: 2,850 lbs.

Volume: 19 cu. ft.

\$1,495.00



Landscape Wall made using the
Multi-Stone Landscape Liner
24" x 48" x 4" (FL-MSL003)
& Corner Liner (FL-MSL121)

With this handy little device there is no need to buy a corner liner for your corner forms. This piece fits into the corner of a corner block form allowing you to use a standard 24" x 48" liner and a 24" x 24" liner to make a corner block.

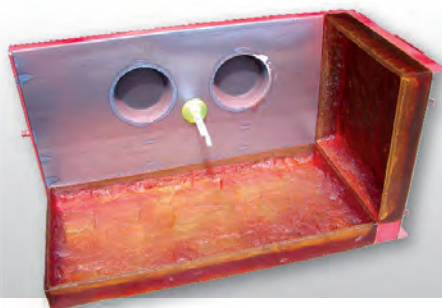

■ 4" X 4" CORNER SHIM

■ Sku Number: LS-SHIM

Liner Weight: 12 lbs.

\$60.00



CORNER BLOCK INSTALLATION

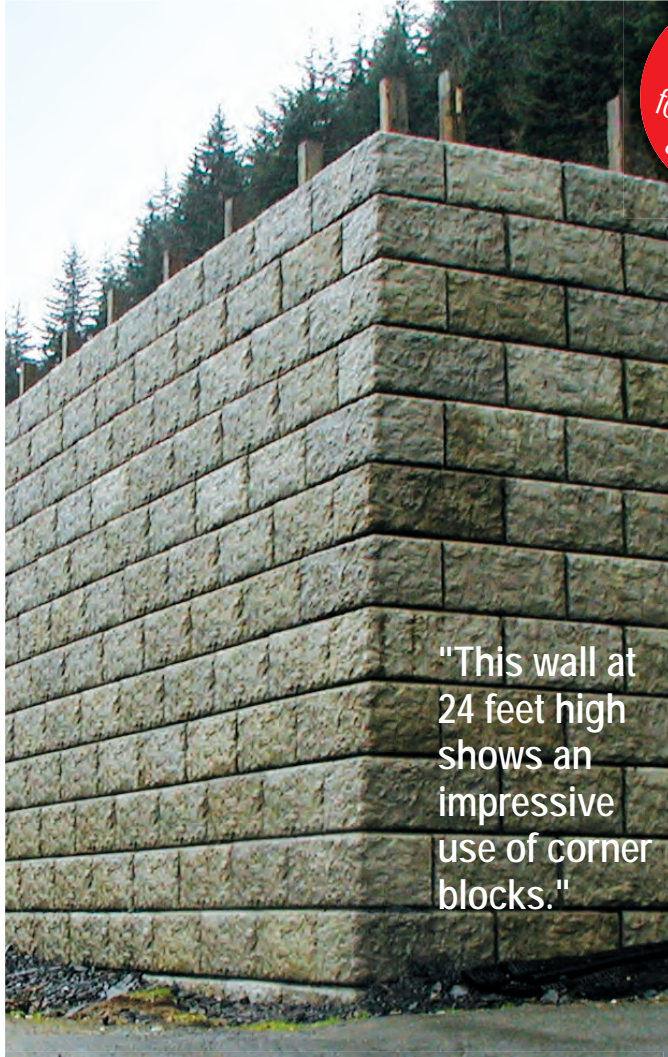

"This wall at 24 feet high shows an impressive use of corner blocks."

Why can't I use a regular form to make a corner?

The Landscape block was

designed to have a 24" x 48" footprint. The 4" depth of the liner makes the block actually 28" deep. The corner form must compensate for this 4" in the other direction.

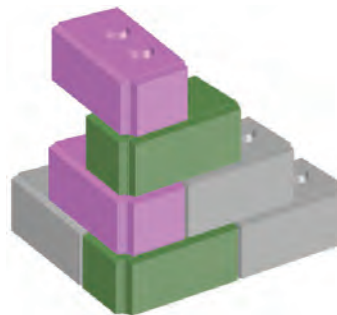

OUTSIDE CORNER

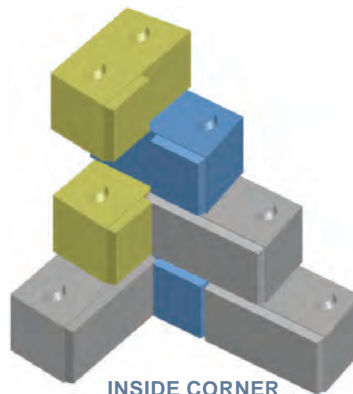

INSIDE CORNER

Creating corners, while simple, has its own set of rules. There are two types of corners you will encounter: Outside and Inside.

With corners, each wall's running bond will be off by 2" on every row. This is an aesthetic matter and not a structural one and can easily be corrected using key blocks.

1 THE OUTSIDE CORNER

The outside corner is made by alternating Left and Right Outside Corner Blocks on each successive course. Remember that each Corner Block will be placed back 2 inches in both directions to account for the wall's setback.

2 THE INSIDE CORNER

To make an inside corner, you'll need an Inside Corner Blockout and an Inside Corner Liner which fit inside a standard form. Because of the geometry of inside corners, the inside knob of each corner block must be blocked out. To compensate, use construction adhesive to lock the block in place. Overlap one Left or Right Inside Corner Block successively on each course to make the corner.

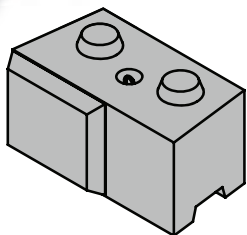

■ 24" X 20" X 4" INSIDE CORNER LINER

■ Sku Number: FL-LDS007
Liner Weight: 30 lbs.

\$310.00

■ 24" X 28" X 4" INSIDE CORNER BLOCKOUT

■ Sku Number: LS-1041
Liner Weight: 42 lbs.

\$225.00

Call Now 218-728-9481

■ LANDSCAPE BLOCK FORMS

So, you've reached the top of your wall. Now what do you do? Top caps may be inappropriate for certain applications so we have developed recess blockouts to help top off your walls.

A recess blockout creates a 6 inch recess in the top of the block. If you are backfilling behind your wall, this void allows you to fill up and over the top of your wall. It is deep enough for any landscaping to take root.

The recess blockouts bolt directly onto your existing form. If you are using a form without tapered ends you will need a Straight End blockout. If you have the tapered ends, get the Tapered End blockout.

Half block dividers are needed for your forms when you are using the recess blockouts. The half block dividers are cut out to fit around the blockout after it is bolted in place.

You can also recess a sloped end block or a corner block. In both instances the recess stops before the end of the block. The recess blockout for sloped end works with the sloped end blockout. The recess blockout for corner works in the corner block form. Each require a separate left and right hand blockout.



■ FULL RECESS BLOCKOUT STRAIGHT ENDS

■ Sku Number: LS-R1010S
Form Weight: 80 lbs
Block Weight: 2,200 lbs
Volume: 14.67 cu. ft.

\$525.00

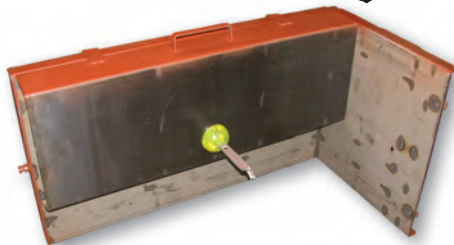
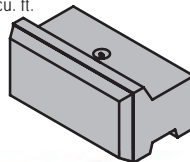

■ FULL RECESS BLOCKOUT TAPERED ENDS

■ Sku Number: LS-R1010T
Form Weight: 80 lbs
Block Weight: 2,100 lbs
Volume: 14.00 cu. ft.

\$525.00

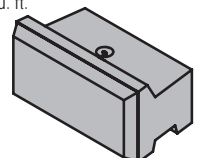

■ RECESS BLOCKOUT FOR SLOPED END

Separate Left and Right block-out required

■ Sku Number Left: LS-R1070L
Sku Number Right: LS-R1070R
Form Weight: 80 lbs
Block Weight: 1,950 lbs
Volume: 6.50 cu. ft.

\$405.00

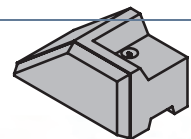

Left block form shown

"If the top of your wall is under your feet, you may want to use recessed blocks."

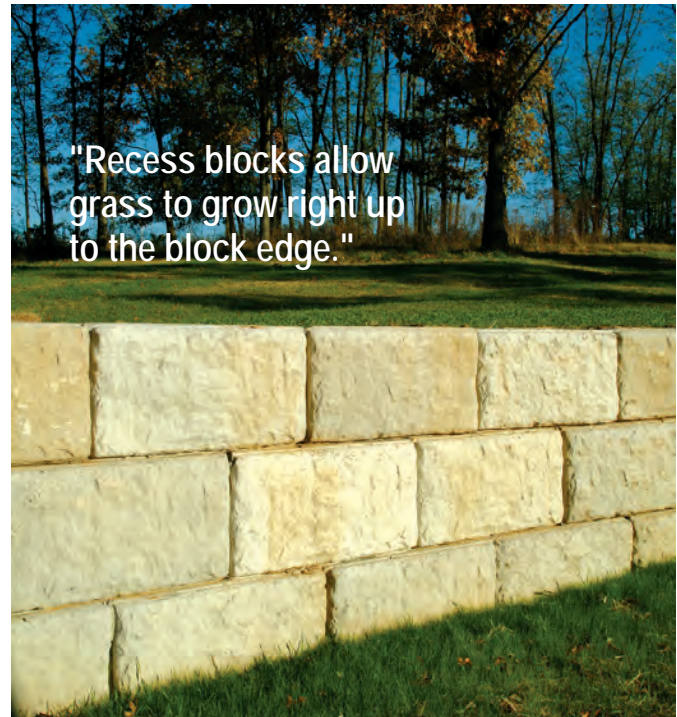

■ HALF BLOCK STRAIGHT RECESSED DIVIDER

■ Sku Number: LS-R1020S
Form Weight: 45 lbs
Block Weight: 1,050 lbs
Volume: 7.00 cu. ft.

\$290.00

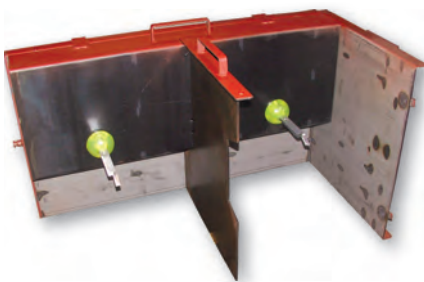
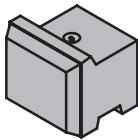

■ HALF BLOCK TAPERED RECESSED DIVIDER

■ Sku Number: LS-R1020T
Form Weight: 55 lbs
Block Weight: 975 lbs
Volume: 6.50 cu. ft.

\$395.00

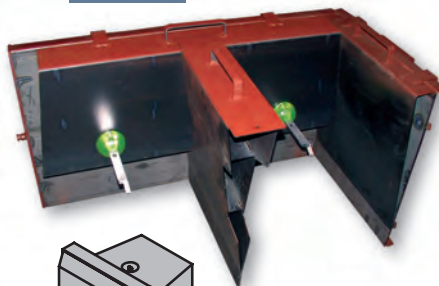
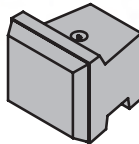

Why buy extra forms when you don't have to? These blockouts fit into your existing forms.

■ RECESS BLOCKOUT FOR CORNER STRAIGHT END

■ Sku Number Left: LS-R1040SL
Sku Number Right: LS-R1040SR
Form Weight: 120 lbs
Block Weight: 2,400 lbs
Volume: 16.00 cu. ft.

\$525.00

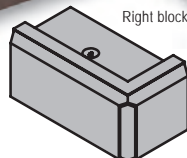
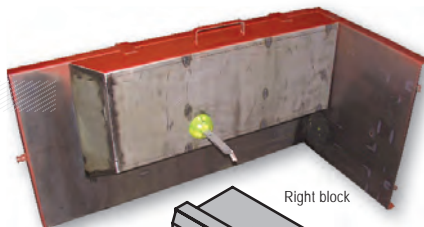

■ RECESS BLOCKOUT FOR CORNER TAPERED END

■ Sku Number Left: LS-R1040TL
Sku Number Right: LS-R1040TR
Form Weight: 120 lbs
Block Weight: 2,400 lbs
Volume: 16.00 cu. ft.

\$525.00

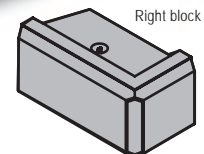
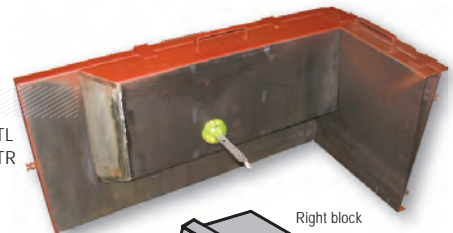

Call Now 218-728-9481

■ LANDSCAPE BLOCK FORMS

■ TOP CAP FORM WORKS WITH STANDARD AND CORNER FORMS



■ Sku Number: LS-1050T
Form Weight: 200 lbs
Block Weight: 1,125 lbs
Volume: 7.50 ft²

\$645.00

Poured upside-down, the Top Cap Form creates a block 8" high, 48" wide at the front and 42" wide at the back. The stone face liners fit into the front and back of the form. When the blocks are laid head to toe they will lie straight. Laid head to head they will curve back. Laid toe to toe they will curve in. The liners have open ends so they will butt seamlessly against the adjoining block face.

■ 8" X 48" X 4" LANDSCAPE TOP CAP LINER

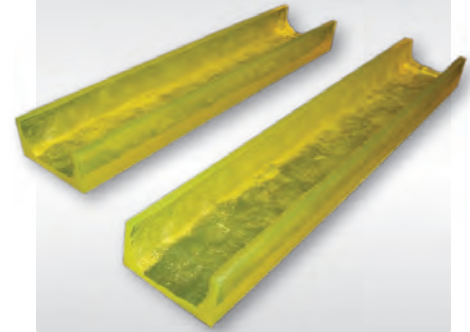

■ Sku Number: FL-LDS302
Form Weight: 45 lbs

\$295.00



How do I handle the Top Cap and Step blocks?

There is no single way to best handle these blocks. Placing a lift point will mar the surface, but can be grouted over. Nuts can be cast in place for use with eye-bolts. Most people simply use straps.

The step form creates one step 30" deep x 48" wide with a 7" high riser and a stone face on three sides. The one piece liner is hinged in the corners to wrap around the front and two sides. To create stairs simply stack one on top of another allowing for desired tread depth.

■ STEP FORM

Sku Number: LS-STEP
Form Weight: 210 lbs
Block Weight: 875 lbs
Volume: 5.83 ft²

\$495.00

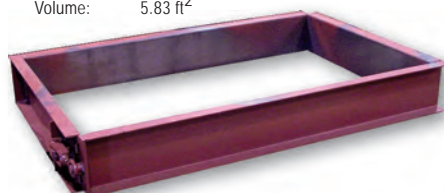

■ 7" X 30" X 7" X 48" LANDSCAPE STEP LINER

Sku Number: FL-LDS301
Form Weight: 40 lbs

\$395.00



■ HALF SLOPED END BLOCKOUT
CREATES BOTH LEFT AND RIGHT SLOPED BLOCKS

■ Sku Number: LS-1070H **\$525.00**
Form Weight: 80 lbs
Block Weight: 2,175 lbs.
Volume: 14.50 cu. ft.

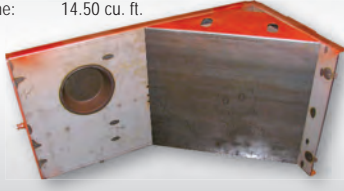

■ 24" X 48" X 4" HALF SLOPED LINER
SEPARATE LEFT AND RIGHT LINERS REQUIRED



RIGHT
■ Sku Number: FL-LDS201
Liner Weight: 55 lbs
\$485.00

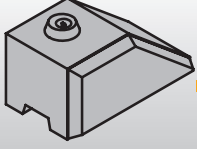

LEFT
■ Sku Number: FL-LDS202
Liner Weight: 55 lbs
\$485.00

Sloped End Blocks are used to transition from one course of blocks to another. This blockout simply sets into the top corner of your landscape block form. The sloped liner fits right up against it. While only one blockout is needed for both left and right sloped block, separate left and right liners are required.

■ FULL SLOPED END BLOCKOUT
CREATES BOTH LEFT AND RIGHT SLOPED BLOCKS

■ Sku Number: LS-1070F **\$595.00**
Form Weight: 80 lbs
Block Weight: 1,545 lbs.
Volume: 10.30 cu. ft.



■ 24" X 48" X 4" FULL SLOPED LINER
SEPARATE LEFT AND RIGHT LINERS REQUIRED



RIGHT
■ Sku Number: FL-LDS203
Liner Weight: 55 lbs
\$470.00



LEFT
■ Sku Number: FL-LDS204
Liner Weight: 55 lbs
\$470.00

"Sloped ends move blocks gradually from course to course."

Call Now 218-728-9481

■ LANDSCAPE BLOCK FORMS

Half-high landscape blocks are lighter and easier to move. They allow you to "step down" the end of a wall less drastically than a 2 foot high block.



■ 12" X 24" X 48"
HALF-HIGH FORM



■ Sku Number: LS-3010S
Form Weight: 260 lbs
Block Weight: 1,275 lbs.
Volume: 8.5 cu. ft.

\$1,095.00

■ 12" X 48" X 4"
LANDSCAPE HALF-HIGH
FORM LINER

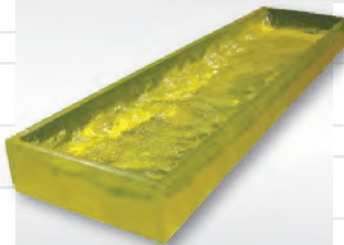

■ Sku Number: FL-LDS014
Form Weight: 35 lbs

\$320.00

■ HALF-HIGH
STRAIGHT DIVIDER

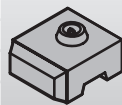
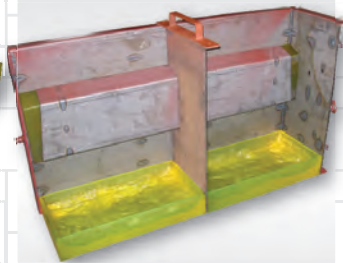

■ Sku Number: LS-3020S
Form Weight: 23 lbs
Block Weight: 675 lbs.
Volume: 4.5 cu. ft.

\$195.00

■ HALF-HIGH
TAPERED DIVIDER

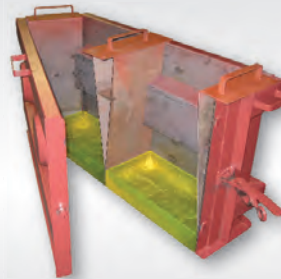

■ Sku Number: LS-3020T
Form Weight: 35 lbs
Block Weight: 600 lbs.
Volume: 4 cu. ft.

\$250.00

■ 12" X 24" X 4"
LANDSCAPE HALF-HIGH
HALF LINER

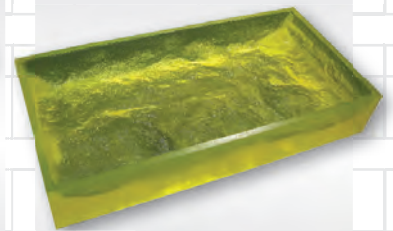

■ Sku Number: FL-LDS017
Form Weight: 20 lbs

\$215.00

■ HALF-HIGH
TAPERED END BLOCKOUTS

(PAIR) • (WORKS WITH STANDARD, SLOPED, AND CORNER FORMS)

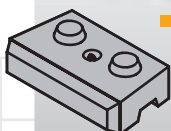

■ Sku Number: LS-3010T
Form Weight: 40 lbs
Block Weight: 1,200 lbs.
Volume: 8 cu. ft.

\$325.00

■ HALF-HIGH
CORNER FORM

CREATES BOTH LEFT AND RIGHT BLOCKS

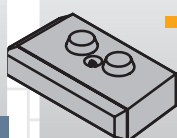

■ Sku Number: LS-3040S
Form Weight: 290 lbs
Block Weight: 1,350 lbs.
Volume: 9 cu. ft.

\$1,295.00

■ 12" X 28" X 12" X 52" X 4"
LANDSCAPE HALF-HIGH
CORNER LINER

CREATES BOTH LEFT AND RIGHT BLOCKS



■ Sku Number: FL-LDS123
Form Weight: 45 lbs

\$565.00

■ 12" X 28" X 12" X 28" X 4"
LANDSCAPE HALF-HIGH
HALF CORNER LINER

CREATES BOTH LEFT AND RIGHT BLOCKS

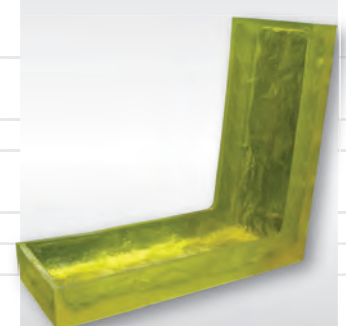

■ Sku Number: FL-LDS124
Form Weight: 45 lbs

\$415.00

BASE BLOCK EXTENSION FORM



Assembly shown at the left is the Base Block Extension Form (LS-1010XS24) bolted to the top of a Standard Landscape Block Form (LS-1010S) SOLD SEPARATELY with Base Block Tapered End Blockouts (LS-2010T) installed.)

■ Sku Number: LS-1010XS24
Form Weight: 225 lbs
Block Weight: 5,100 lbs
Volume: 34.00 cu. ft.

\$895.00

BASE BLOCK

Tapered End
Blockouts
(Pair)

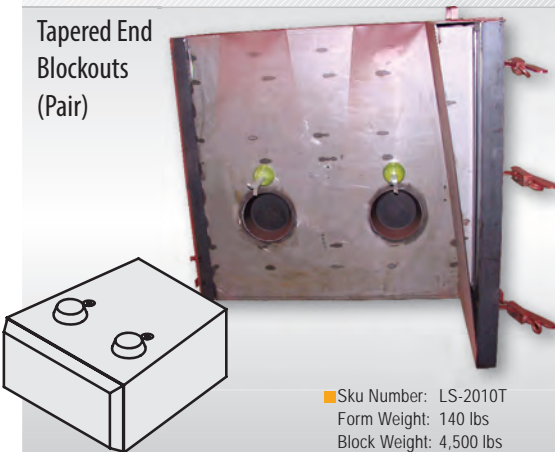

■ Sku Number: LS-2010T
Form Weight: 140 lbs
Block Weight: 4,500 lbs
Volume: 30.00 cu. ft.

\$630.00

BASE BLOCK

Tapered Half Block Divider

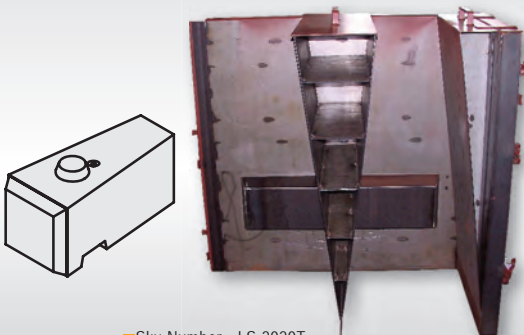

■ Sku Number: LS-2020T
Form Weight: 120 lbs
Block Weight: 2,430 lbs
Volume: 16.20 cu. ft.

\$630.00

Do you want to go higher?

To make a 24" high x 48" wide x 52" deep Base Block you can bolt the Base Block Extension Form (LS-1010XS24) to a Standard Straight Landscape Form (LS-1010S). Additional Flexibility - when you are done pouring Base Blocks you can unbolt the Extension and go back to pouring Standard Landscape Blocks.

The Base Block has the same face dimensions as the landscape block but it is twice as deep. So, at 24" high x 48" wide x 52" deep, the base block provides a large surface area for a very stout wall.

The Base Block interlocks with the standard landscape block, so you can mix and match as you see fit.

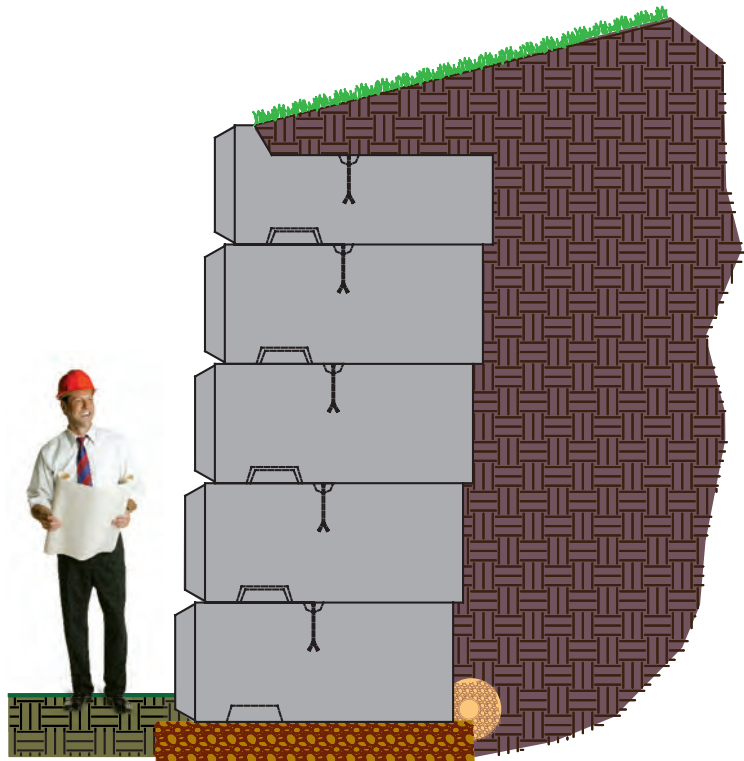

Need a Wall Engineered?

You can download some Basic Engineering off of our website at www.worldblock.com under the Engineering tab.

This information will assist you with walls up to 8 feet tall that may not require a licensed engineer.

The wrong time to get an engineer involved is after the wall is installed! If you need assistance designing your wall, we recommend that you contact Mike Orton at Hardscape Technical Services mikeorton@hardscapetech.com



If you are looking for a landscape block that is small enough to be handled with light-duty equipment, the Mid-size Landscape Block Form is the perfect form for you.

The Mid-Size Landscape Block looks great in residential settings. Where larger blocks tend to overwhelm the scale of a house, the Mid-Size Block looks right at home, even though the wall has the same mass as one built from our larger Land-

scape Blocks. Each block weighs only 560 pounds. That's light enough to be handled with a skid-steer. Why is that important?

Landscape contractors typically do not have the heavy equipment needed to move and place larger blocks. The Mid-Size Landscape Block is small enough to handle and allows them to move up in class beyond the small blocks sold at hardware stores.

The Mid-Size Landscape

Block steps back one inch on every course allowing it to lean back into the earth it is retaining. And with tapered sides, the Mid-Size Landscape Block can create curved walls with a radius as tight as 6 feet to the back of the block.

We offer two styles of forms: the single cavity which makes one block at a time and the 6' Form that has the option to pour (3) 2' blocks or (1) 6' block (by removing the two dividers and installing the

end spacer.

Working with either of the Mid-Size Landscape Forms is as simple as all the rest of our forms. Two "L" shaped halves snap together with heavy-duty, over-center locking clamps. The blocks are poured face down with a liner placed on the bottom to create the rock face of the block.

* For the Mid-Size block use the 1/4x6 U-Anchor (AC-021) with the 1/4" U-Anchor Blockout (AC-020)

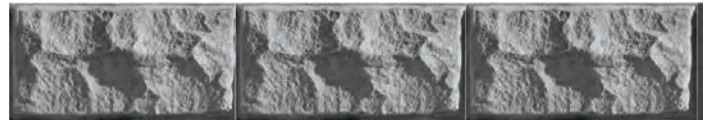

(6' Block with End Spacer installed)



■ **MID-SIZE LANDSCAPE
BLOCK FORM**

(MAKES one 6' or three 2' BLOCKS)

Sku Number: MS-1030T

Block Weight: 6' (1,700 lbs) or 2' (560 lbs)

Volume: 6' (11.33 cu ft) or 2' (2.70 cu ft)

Form Weight: 395 lbs.

(Form includes (1) End Spacer and (2) Half Dividers)

\$1,895.00

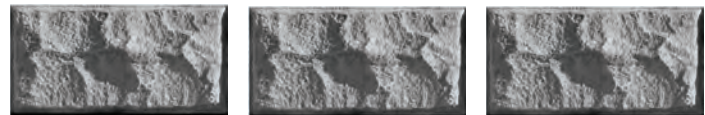

(Three 2' Blocks with two Half Dividers Installed)



Below are the included accessory part numbers if you need to order them separately:



■ **MID-SIZE HALF
BLOCK DIVIDER**

Sku Number: MS-1020
Weight: 35 lbs

\$225.00



■ **MID-SIZE
END SPACER**

Sku Number: MS-1020ES
Weight: 25 lbs

\$140.00

■ MID-SIZE LANDSCAPE BLOCK FORMS

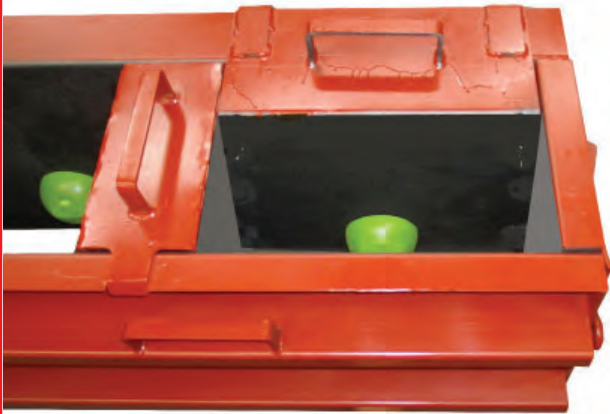

■ TOP RECESS BLOCKOUTS

■ TOP RECESS FOR 2' BLOCK

Sku Number: MS-R1010
Form Weight: 30 lbs

\$225.00

■ TOP RECESS FOR 22" KEY BLOCK

Sku Number: MS-R1050
Form Weight: 26 lbs

\$220.00

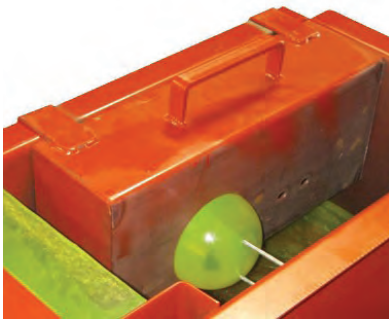

■ TOP RECESS FOR CORNER BLOCK

Sku Number: MS-R1040
Form Weight: 30 lbs

\$225.00



■ TOP RECESS FOR 6' BLOCK

Sku Number: MS-R1030T
Form Weight: 100 lbs

\$625.00



■ TOP RECESS HALF BLOCK DIVIDER

Sku Number: MS-R1020B
Form Weight: 30 lbs

\$220.00





■ **CORNER BLOCK FORM**

(MAKES BOTH LEFT AND RIGHT BLOCKS)

Sku Number: MS-1040FL
Block Weight: 405 lbs
Volume: 2.70 cu. ft.
Form Weight: 125 lbs

\$675.00

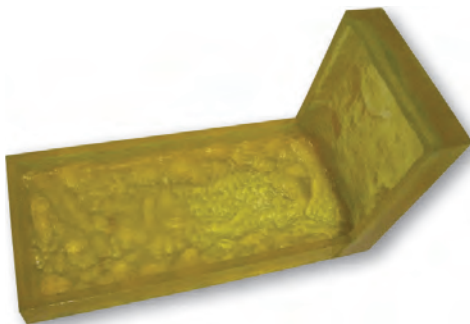
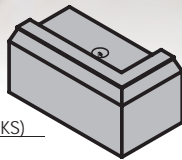

■ **12"X15"X3" X 12"X27"X3"**
CORNER BLOCK LINER

Sku Number: FL-MDS125
Form Weight: 30 lbs

\$375.00

Corner blocks are used when you need to turn a 90° outside corner. It also can be used to simply create a textured face at the end of a wall to finish it off. The "L" shaped liner fits in the bottom and up one side of the form. While a separate left and right form are required, the liner will fit in both the left and right forms by simply flipping it over.



■ **3" X 3" CORNER SHIM**

With this handy little device there is no need to buy a corner liner for your corner forms. This piece fits into the corner of a corner block form allowing you to use a standard 12 x 24 liner and a 12 x 12 liner to make a corner block.

Sku Number: MS-SHIM
Form Weight: 5 lbs

\$30.00



■ MID-SIZE LANDSCAPE BLOCK FORMS

TOP CAP FORM

Sku Number: MS-1050F
Block Weight: 450 lbs
Volume: 3.00 cu. ft.
Form Weight: 150 lbs

\$400.00

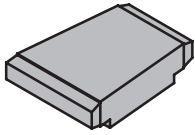

■ 6" X 24" X 3"

TOP CAP LINER

(PAIR)

Sku Number: FL-MDS303
Form Weight: 15 lbs

\$180.00

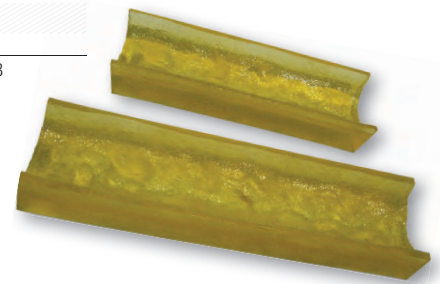

The Top Cap Form creates a block 6 inches high, 24 inches wide at the front and 18 inches wide at the back. The liners fit into the front and back of the form. When the blocks are laid head to toe they will lie straight.

Laid head to head they will curve back. Laid toe to toe they will curve in. The liners have open ends so they will butt seamlessly against the adjoining block face.

This form creates one step 30" deep x 48" wide with a 7" high riser and a stone face on three sides. To create stairs simply stack one on top of another allowing for desired tread depth. The one piece "U" shaped liner wraps around the front and two sides.

■ 7"X30" X 7"X48" LANDSCAPE STEP LINER

Sku Number: FL-LDS301
Form Weight: 40 lbs

\$395.00

STEP FORM

Sku Number: LS-STEP
Block Weight: 875 lbs
Volume: 5.83 cu. ft.
Form Weight: 210 lbs

\$495.00





RECESS BLOCKOUT

Sku Number: MS-R1010
Block Weight: 520 lbs
Volume: 3.47
Form Weight: 30 lbs

\$225.00

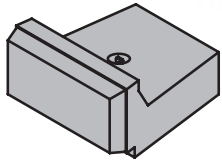
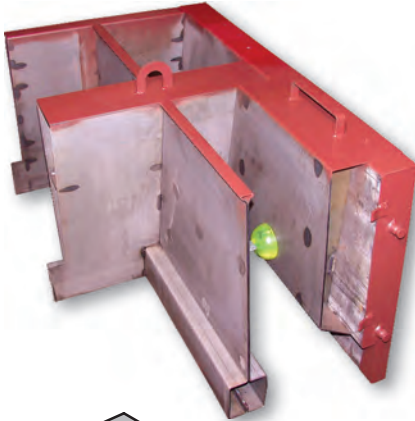

"Recess Blockouts allow you to place sod or rock within 3" of the face of the block."

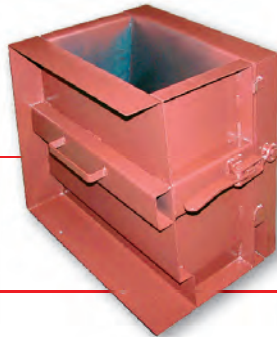

SINGLE CAVITY MID-SIZE LOCK FORM

Sku Number: MS-10101
Block Weight: 560 lbs
Volume: 3.37 cu. ft.
Form Weight: 156 lbs

\$575.00

THE PROBLEM:

Mid-Size Landscape blocks step back 1 inch on every course. When using corner blocks, they also step in 1 inch to adjust for the wall running in the other direction. If only one corner block is used, this offset is unnoticeable and easy to deal with. When using two corners, as shown below, the wall gets squeezed 2 inches on each course.

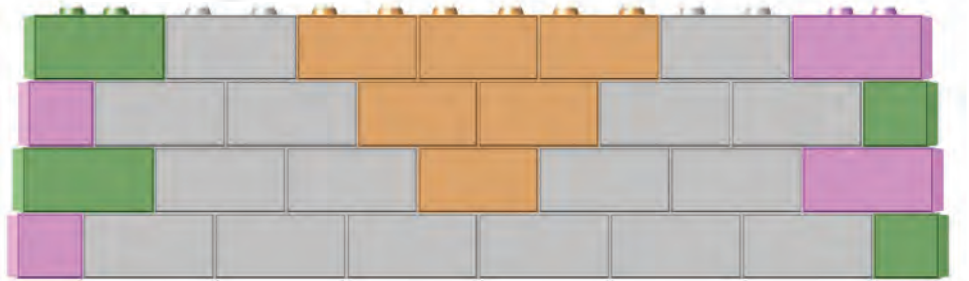

THE SOLUTION:

Key blocks are 2 inches shorter than the standard block - 22 inches versus 24. Use one additional key block for each successive course feeling the squeeze. For example, on the first course no key blocks are required. The second course needs one key block, the third course needs two, the fourth course needs three, and so on.

KEY BLOCK BLOCKOUT

Sku Number: MS-1030B
Block Weight: 500 lbs
Volume: 3.33
Form Weight: 25 lbs

\$150.00



KEY BLOCK LINER

Sku Number: FL-MDS019
Form Weight: 13 lbs

\$200.00

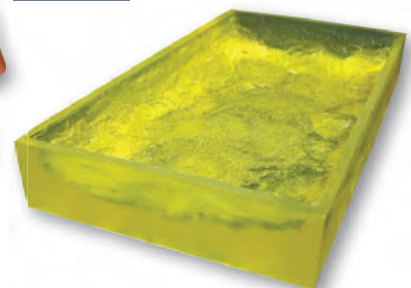

MID-SIZE LANDSCAPE BLOCK FORMS

■ QUARRY STONE LINER

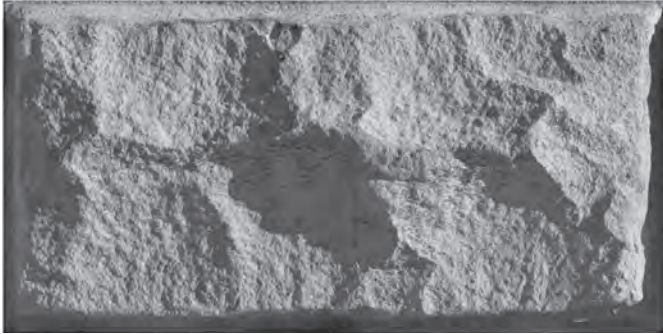

■ 12" X 24" X 3" QUARRY STONE LANDSCAPE LINER

Sku Number: FL-MSQ017
Weight: 20 lbs

\$215.00

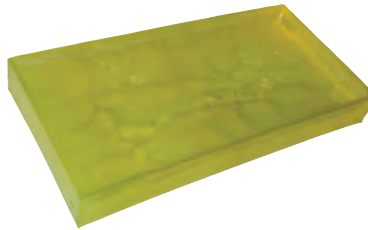

■ MID-SIZE ORIGINAL LINER



■ 12" X 24" X 3" MID-SIZE ORIGINAL LANDSCAPE LINER

Sku Number: FL-MDS017
Form Weight: 20 lbs

\$215.00

■ 12" X 12" X 3" QUARRY STONE HALF-BLOCK LINER

Sku Number: FL-MSQ020
Weight: 7 lbs

\$125.00

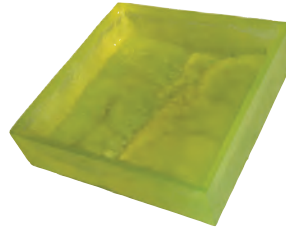

■ 12" X 12" X 3" MID-SIZE ORIGINAL HALF-BLOCK LINER

Sku Number: FL-MDS020
Form Weight: 7 lbs

\$125.00

■ 12" X 15" X 12" X 27" X 3" QUARRY STONE CORNER LINER

Sku Number: FL-MSQ125
Weight: 30 lbs

\$375.00



■ 12" X 15" X 12" X 27" X 3" ORIGINAL CORNER LINER

Sku Number: FL-MDS125
Form Weight: 30 lbs

\$375.00

■ 12" X 22" X 3" QUARRY STONE KEY BLOCK LINER

Sku Number: FL-MSQ019
Weight: 18 lbs

\$200.00

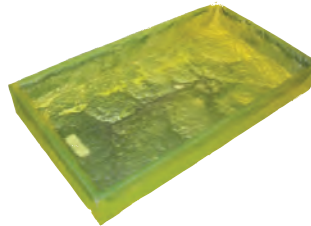

■ 12" X 22" X 3" MID-SIZE ORIGINAL KEY BLOCK LINER

Sku Number: FL-MDS019
Form Weight: 18 lbs

\$200.00

■ 6" X 24" X 3" / 6" X 18" X 3" QUARRY STONE TOP CAP LINER

Sku Number: FL-MSQ303
Form Weight: 16 lbs

\$180.00



■ 6" X 24" X 3" / 6" X 18" X 3" ORIGINAL TOP CAP LINER

Sku Number: FL-MDS303
Form Weight: 16 lbs

\$180.00

DAYTON SUPERIOR Q-2 VOC RELEASE AGENT

This release agent is formulated with organic chemicals to prevent adhesion for quick, easy release of your forms and liners. Cuts clean-up time and will create a rust proof film on your forms. Can be stored indefinitely.

\$135.00

■ Sku Number: AC-120
Weight: 43 lbs

5 Gallons



Which Release Agent to Use?

To prolong the life of your World Block Formliners, we recommend using either Unitex Q-2 VOC or Grifcote FR-50-VOC release agent.

To find your local distributor for Unitex visit www.daytonsuperior.com and for Grifcote visit www.hillandgriffith.com.

SPRAYER

How do you apply release agent? The easiest way is to spray it on. Our Industrial Sprayer is built specifically for release agents by spraying 30-35% solids. It has a wide mouth for easy filling and cleaning. A heavy duty brass pump with an ergonomic pump handle makes pressurizing the tank easy and comfortable. A curved brass extension wand for getting into the nooks and crannies makes this the perfect tool to use with Dayton Superior Q-2 VOC.

\$150.00

■ Sku Number: SP-060
Weight: 11 lbs



\$29.75

■ Sku Number: AC-140
Weight: 3.5 lbs

10" HEAVY-DUTY, OVER-CENTER LOCKING CLAMPS

All of World Block forms are built using these heavy duty clamps. They hold tight by snapping locked over center. The bent handle offers an easy grip. The fine thread eyebolt offers accurate adjustments and stronger resistance to force.



\$5.30

■ Sku Number: AC-190
Weight: .7 lbs

\$5.20

■ Sku Number: AC-180
Weight: .6 lbs

\$5.10

■ Sku Number: AC-160
Weight: .5 lbs

CLAMP LUGS

The 3/4" diameter clamp lugs with radius notch are designed to work precisely with either our 10" or 15" over center locking clamps.



\$45.00

■ Sku Number: AC-111
Weight: 5 lbs

RUBBER KNOB BLOCKOUT

Bolts into the raised knobs of your form to create a flat surface on top of your block.

Call Now 218-728-9481

■ U-ANCHORS & BLOCKOUTS

7/16" Liftpoint Blockout for "V"

Sku Number: AC-040V

Weight: 2 lbs.

\$30.00

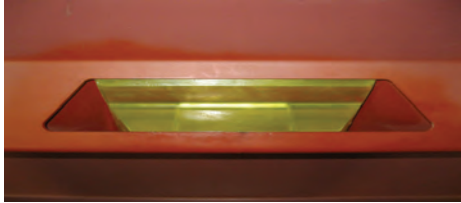

This Urethane blockout installs into the cutout on the outside of your V-Interlock form and works with the 7/16" U-Anchor (Sku Number AC-041). No bolts required for installation.



Blockout - 8" Square w/ 1/2" Slot - Rebar Liftpoint

Sku Number: AC-010SQ

Weight: 6 lbs.

\$55.00



This Urethane blockout has a 1/2" wide slot & will accommodate rebar bent at 90 degrees or the 7/16" U-Anchor (AC-041). The best way to keep the rebar or U-Anchor in place while pouring is to tightly jam crumpled up newspaper into the slot after insertion. This blockout stays with the form when stripping, there is no need to unbolt it each time! Attaches with 2 thumb screws (included).



Rebar Liftpoint Blockout - Bolted

Sku Number: AC-010

Weight: 3 lbs.

\$30.00

The Rebar Liftpoint Blockout is another alternative when using a bent piece of rebar as your lift point. This blockout has a "tooth" that holds the rebar in place while pouring. This blockout requires that you remove the bolts each time before stripping - you can then pop the blockout out from the concrete. This blockout can also be used with U-Anchors.





1/4" LIFTPoint BLOCKOUT

Fits 1/4" U-Anchor and 1/4" Lifting Loop



\$30.00

1/4" BLOCKOUT

■ Sku Number: AC-020
Weight: 2 lbs

3/8" LIFTPoint BLOCKOUT

Fits 3/8" U-Anchor and 3/8" Lifting Loop



\$30.00

3/8" BLOCKOUT

■ Sku Number: AC-030
Weight: 2 lbs

7/16" LIFTPoint BLOCKOUT

Fits 7/16" U-Anchor



\$30.00

7/16" BLOCKOUT

■ Sku Number: AC-040
Weight: 2 lbs

1/4" U-ANCHOR

For use with Mid-Size Landscape block forms
(Rated to 1,600 lbs)

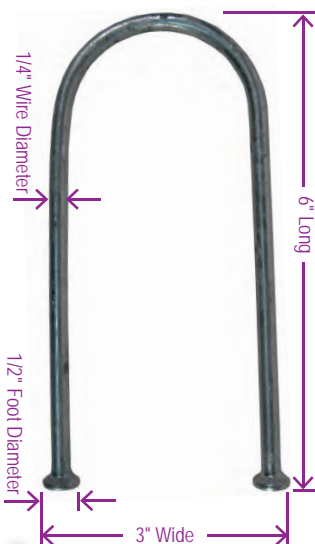

\$1.45

■ Sku Number: AC-021
Weight: 2.7 oz.

Only: \$1.25 when
ordering 100+

3/8" U-ANCHOR

For use with Landscape and 24 x 48 Knob Style
block forms (Rated to 4,690 lbs)

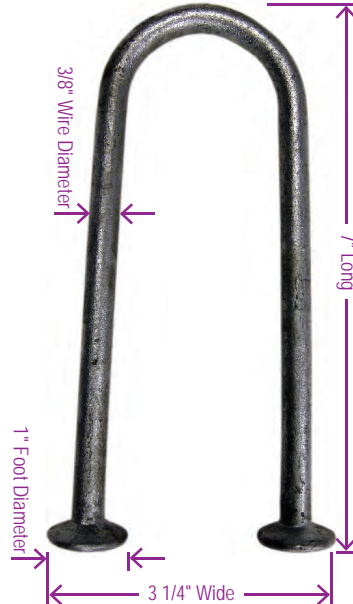

\$1.85

■ Sku Number: AC-031
Weight: 8.8 oz.

Only: \$1.65 when
ordering 100+

7/16" U-ANCHOR

For use with V-Interlock and 30 x 60 Knob Style
block forms (Rated to 7,500 lbs)

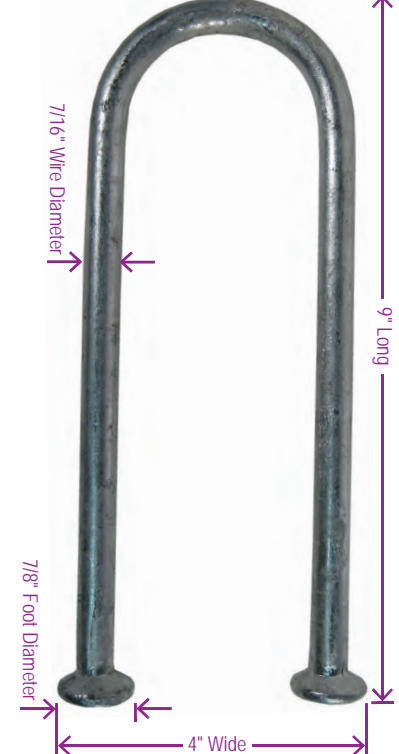

\$2.55

■ Sku Number: AC-041
Weight: 16.5 oz.

Only: \$2.35 when
ordering 100+

U-ANCHORS

Made of galvanized carbon steel to prevent rust, the U-Anchor is the most economical lifting anchor on the market. U-anchors were designed specifically for lifting precast modular blocks.



WORLDBLOCK

3964 E Calvary Road
Duluth, MN 55803

WE ARE PROUD TO
BE AN EMPLOYEE-
OWNED COMPANY
SINCE 2020